



DAMEN ROTATION ANGLE TRANSMITTER

GENERAL

The rotation angle transmitter has been designed for shaft angles or rotations and suction tube position angles, in horizontal plane. The angle transmitter is mounted in a stainless steel casing and is oil filled for pressure compensation. The shaft is also made of stainless steel.

This heavy-duty transmitter is specially designed for harsh and abrasive environments.

A mounting bracket and protection cover is universal applicable together with a lever for positioning the shaft. The sensor has a standard industrial output of 4 to 20 mA in 2-wire configuration.

The standard version is provided with a Subconn® subsea connector.

For the electrical cable connection a protection cage is provided.

FEATURES

- Vibration proof
- High accuracy
- Measurements range 355° max.
- Supply voltage 24 Vdc
- Signal output 4 to 20 mA
- Watertight up to 1000 mWC
- Corrosion resistant
- Universal mounting bracket with lever
- Operation temperature 0°C to +50°C
- Dry weight 17 kg

DAMEN

TECHNICAL DATA

ROTATION ANGLE TRANSMITTER

Max. rotation angle 360°
 Other types or ranges on request
 Calibration certificate
 Stainless steel housing IP-68 with Subconn connector
 Special cable with Subconn® connector
 (standard DGC-405 cable 25 m)
 Other length cable on request
 Power supply 24 Vdc
 Signal output 4 to 20 mA

Standard

-
-
-
-
-

Optional

-
-

GENERAL SPECIFICATIONS

Stainless steel	: 200 x 150 mm (HxD)
Protection class	: IP-68
Operation temperature	: -10°C to + 60°C
Max. Load impedance	: 600 ohm (at 24 Vdc supply)
Sense of rotation	: clockwise (=increased output)
Max. loop current	: approx. 24 mA
Dry weight	: 12 kg
Linearity	: ± 0,1 %
Resolution	: 0.2 %
Shock max.	: 10 g

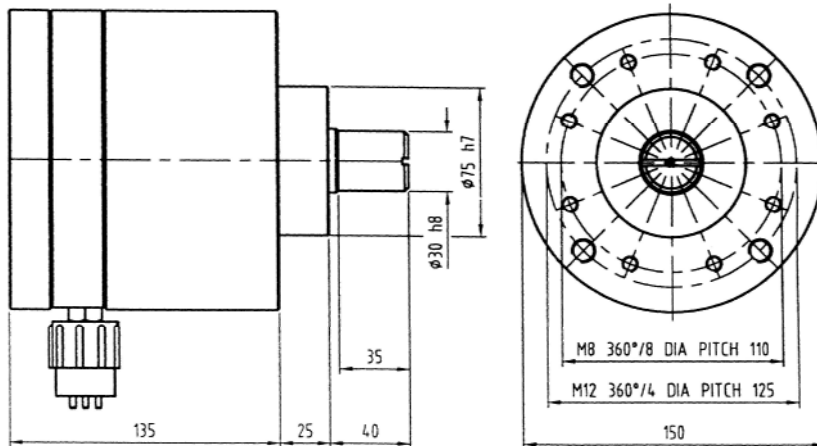

DAMEN ROTATION ANGLE TRANSMITTER

DAMEN

DAMEN DREDGING EQUIPMENT

Member of the DAMEN SHIPYARDS GROUP



Edisonstraat 32
 3861 NE Nijkerk

P.O. Box 1021
 3860 BA Nijkerk
 The Netherlands

phone +31 (0)33 247 40 40
 fax +31 (0)33 247 40 70

info@damendredging.com
 www.damendredging.com